

# PAVILON A8

## PŮDORYS II.NP

m 1:100 +4,000

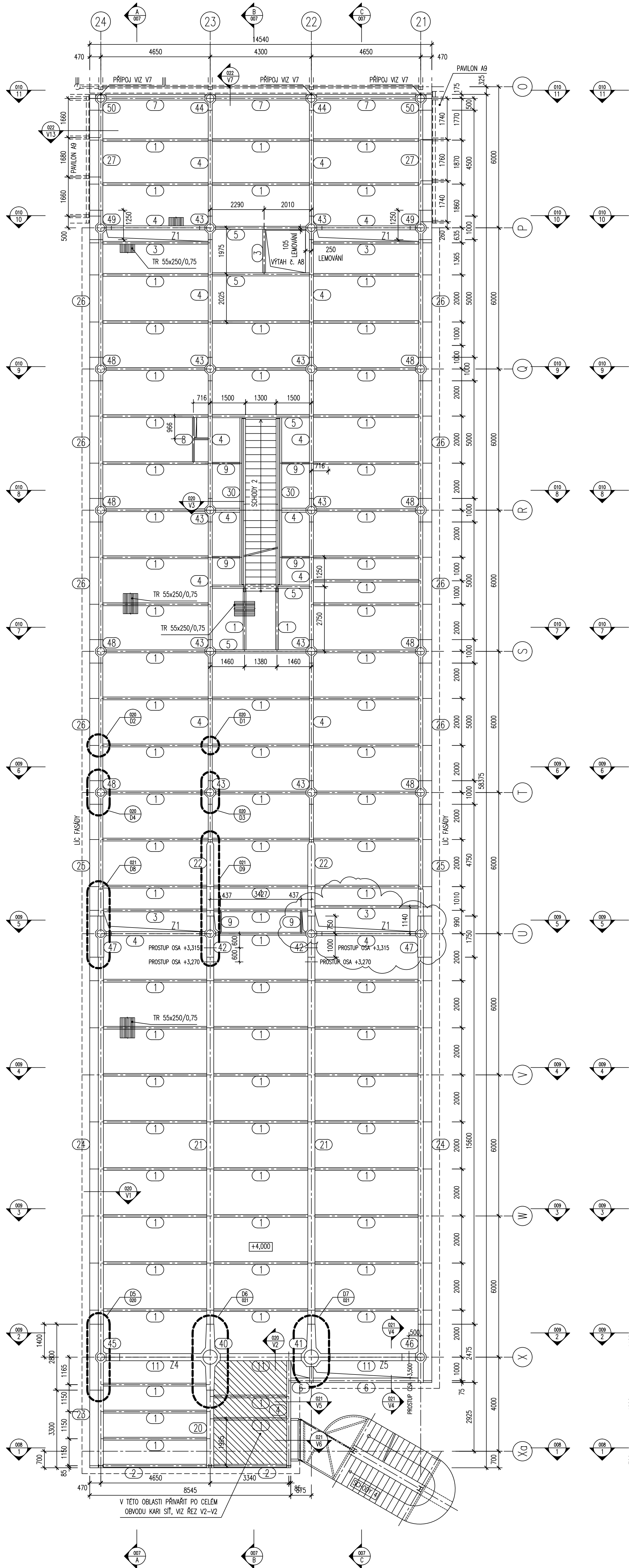

## PŮDORYS III.NP

m 1:100 +7,800

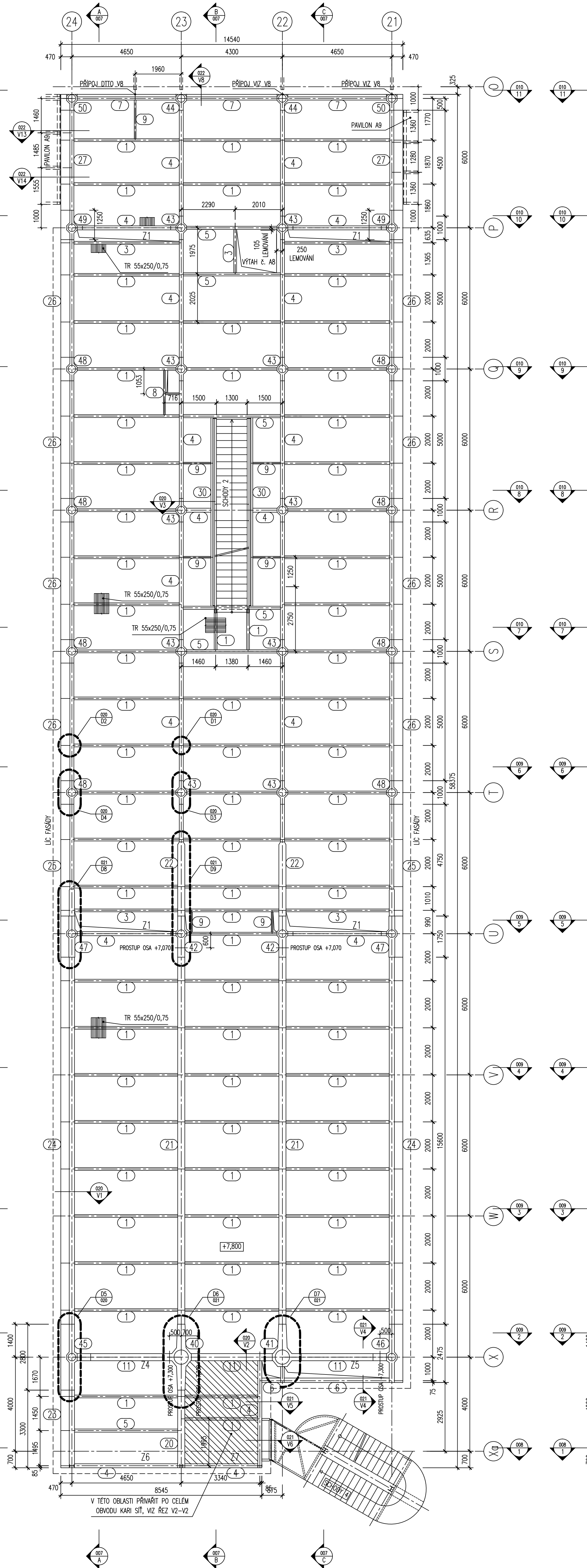

## PŮDORYS STŘECHY

m 1:100 +11,520 (ÚROVEŇ ŽEL. BET. DESKY)

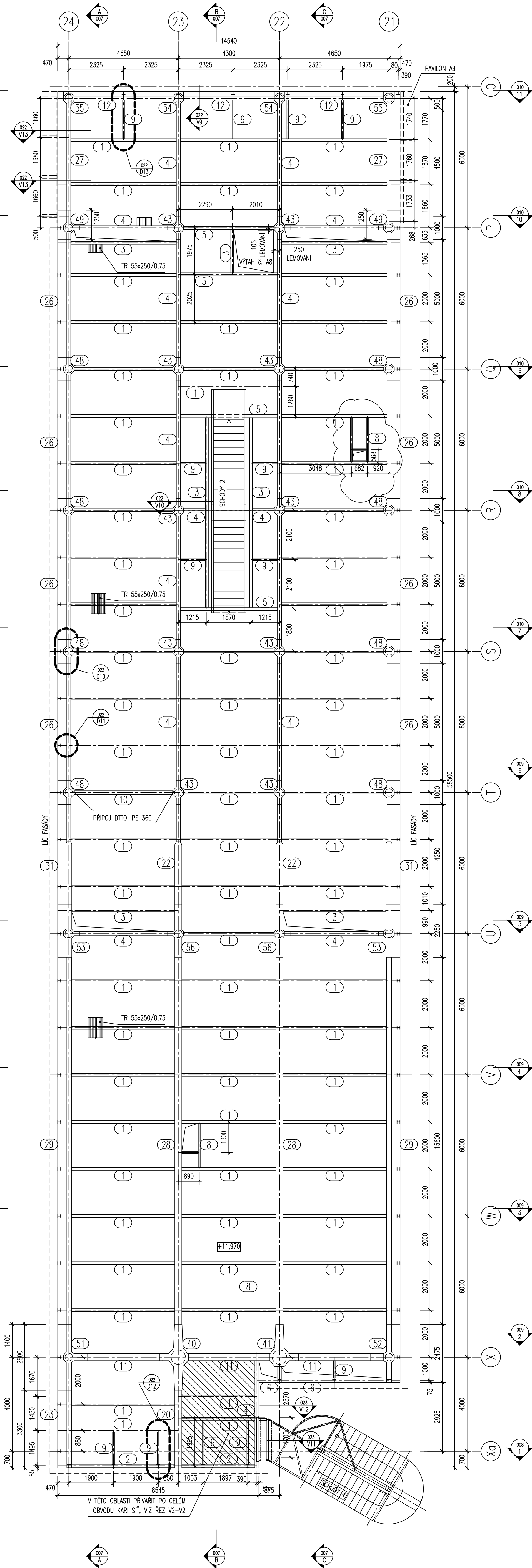

TABULKA NADVÝŠENÍ (mm)

| ŘADA / ŘADA       | II. NP | III. NP | STŘECHA | POZNÁMKA        |
|-------------------|--------|---------|---------|-----------------|
| Xa / 22 (-960 mm) | 25     | 25      | 25      |                 |
| Xa / 23           | 15     | 15      | 15      |                 |
| Xa / 24           | 0      | 0       | 0       |                 |
| W / 21-23         | 25     | 25      | 30      | 200MM PŘED OSOU |
| V / 21-23         | 25     | 25      | 30      | 200MM ZA OSOU   |
| W / 24            | 35     | 35      | 35      | 200MM PŘED OSOU |
| V / 24            | 30     | 30      | 30      | 200MM ZA OSOU   |

TABULKA PROFILŮ

| ČÍSLO | POPIS PROFILU  | KOTY HORNÍ PŘÍRUBY |               |            | OCEL | POZNÁMKA               |
|-------|--|--------------------|---------------|------------|------|------------------------|
|       |  | II.NP +4,000       | III.NP +7,800 | S2 +11,760 |      |                        |
| 1     | PE 240   | +3,800             | +7,600        | +11,400    | S235 |                        |
| 2     | PE 240+Přib(25+120)  | +3,800             | +7,600        | +11,400    | S235 | Lemování               |
| 3     | PE 240+Přib 120  | +3,800             | +7,600        | +11,400    | S235 | Lemování               |
| 4     | PE 300   | +3,920             | +7,720        | +11,520    | S355 |                        |
| 5     | PE 270   | +3,800             | +7,600        | +11,400    | S235 |                        |
| 6     | PE 300+2xL40x4+2xP4x40                                       | +3,920             | +7,720        | +11,520    | S235 |                        |
| 7     | PE 270+Přib(15+120)  | +3,800             | +7,600        | +11,400    | S235 |                        |
| 8     | PE 160   | +3,800             | +7,600        | +11,400    | S235 | lemování prostupů+Přib |
| 9     | PE 140   | +3,800             | +7,600        | +11,400    | S235 |                        |
| 10    | IPE 300  | +3,920             | +7,720        | +11,520    | S235 |                        |
| 11    | 2xP300x20 st.10, H=800                                       | +3,920             | +7,720        | +11,520    | S355 |                        |
| 12    | IPE 270+Přib(23+120)   | +3,800             | +7,720        | +11,400    | S235 |                        |
| 20    | 2xP300x30 st.10, H=800-360                                   | +3,920             | +7,720        | +11,520    | S355 |                        |
| 21    | 2xP300x20 st.10, H=800                                       | +3,920             | +7,720        | +11,520    | S355 |                        |
| 22    | 2xP300x20 st.10, H=800 +naběh H=800-360, IPE360              | +3,920             | +7,720        | +11,520    | S235 |                        |
| 23    | 2xP220x16 st.8, H=800-360 +Přib(470+120)+ L30/3              | +3,920             | +7,720        | +11,520    | S235 |                        |
| 24    | 2xP220x20 st.8(10), H=800 +Přib(470+120)+ L30/3              | +3,920             | +7,720        | +11,520    | S355 |                        |
| 25    | IPE360 +naběh(220x20 st.8, H=800-360)+Přib(47...)+L30/3      | +3,920             | +7,720        | +11,520    | S235 |                        |
| 26    | IPE 360 +Přib(470+120)+ L30/3                                | +3,920             | +7,720        | +11,520    | S235 |                        |
| 27    | IPE 360 +Přib(470+120)                                       | +3,920             | +7,720        | +11,520    | S235 |                        |
| 28    | 2xP300x20 st.10(12), H=800                                   | +3,920             | +7,720        | +11,520    | S355 |                        |
| 29    | 2xP220x25 st.8(10), H=800 +Přib(470+120)+ L30/3              | +3,920             | +7,720        | +11,520    | S355 |                        |
| 30    | Přib(270+150)+2xPřib(80                                      |                    |               |            | S235 | lemování schodiště     |
| 31    | 2xP220x25 st.10, H=800 +naběh H=800-360, IPE360+Přib(8       | +3,920             | +7,720        | +11,520    | S235 |                        |
| 40    | Havice 2800x800, P30x1220-320, H=800 st.16                   | +3,920             | +7,720        | +11,520    | S355 |                        |
| 41    | Havice 1800x800, P20x1220-320, H=800 st.16                   | +3,920             | +7,720        | +11,520    | S355 |                        |
| 42    | Havice 1750x800, P30x450-300, H=800 st.14                    | +3,920             | +7,720        | +11,520    | S355 |                        |
| 43    | Havice 1600x800, P30x450-170, H=360 st.10                    | +3,900             | +7,720        | +11,520    | S235 |                        |
| 44    | Havice 875x450, P16x450-170, H=360 st.10                     | +3,920             | +7,720        | +11,520    | S235 |                        |
| 45    | Havice 2800x800, P20x450-220, H=800 st.12+ Přib(47...)+L30/3 | +3,920             | +7,720        | +11,520    | S355 | Přib(47... ) je S235   |
| 46    | Havice 2475x800, P20x450-220, H=800 st.12+ Přib(47...)+L30/3 | +3,920             | +7,720        | +11,520    | S355 | Přib(47... ) je S235   |
| 47    | Havice 1750x800, P25x450-250, H=800 st.12+ Přib(47...)+L30/3 | +3,920             | +7,720        | +11,520    | S355 | Přib(47... ) je S235   |
| 48    | Havice 6 43 +Přib(470+120)+ L30/3                            | +3,920             | +7,720        | +11,520    | S235 |                        |
| 49    | Havice 1250x450, P16x450-170+360 st.10+ Přib(470+120)        | +3,920             | +7,720        | +11,520    | S235 |                        |
| 50    | Havice 6 44 +Přib(470+120)                                   | +3,920             | +7,720        | +11,520    | S235 |                        |
| 51    | Havice 2800x800, P25x450-220, H=800 st.12+ Přib(47...)+L30/3 | +3,920             | +7,720        | +11,520    | S355 | Přib(47... ) je S235   |
| 52    | Havice 2475x800, P25x450-220, H=800 st.12+ Přib(47...)+L30/3 | +3,920             | +7,720        | +11,520    | S355 | Přib(47... ) je S235   |
| 53    | Havice 2250x800, P25x450-250, H=800 st.14+ Přib(47...)+L30/3 | +3,920             | +7,720        | +11,520    | S355 | Přib(47... ) je S235   |
| 54    | Havice 880x450, P16x450-170, H=360 st.10                     | +11,520            |               |            | S235 |                        |
| 55    | Havice 6 54 +Přib(470+120)                                   | +3,920             | +7,720        | +11,520    | S235 |                        |
| 56    | Havice 2250x800, P30x450-300, H=800 st.14                    | +3,920             | +7,720        | +11,520    | S355 |                        |
| 57    | Tras24x12,5  |                    |               |            | S355 | Sloup                  |
| 58    | Tras24x16  |                    |               |            | S355 | Sloup                  |
| 59    | Tras24x20  |                    |               |            | S355 | Sloup                  |
| 60    | Tras24x25  |                    |               |            | S355 | Sloup                  |
| 61    | Tras24x30  |                    |               |            | S355 | Sloup                  |
| 62    | Tras24x36  |                    |               |            | S355 | Sloup                  |
| 63    | Tras24x45  |                    |               |            | S355 | Sloup                  |
| 64    | Tras24x54  |                    |               |            | S355 | Sloup                  |
| 65    | Tras24x63  |                    |               |            | S355 | Sloup                  |
| 66    | Tras24x72  |                    |               |            | S355 | Sloup                  |
| 67    | Tras24x81  |                    |               |            | S355 | Sloup                  |
| 68    | Tras24x90  |                    |               |            | S355 | Sloup                  |
| 69    | Tras24x100   |                    |               |            | S355 | Sloup                  |
| 70    | Tras24x110   |                    |               |            | S355 | Sloup                  |
| 71    | Tras24x120   |                    |               |            | S355 | Sloup                  |
| 72    | Tras24x130   |                    |               |            | S355 | Sloup                  |
| 73    | Tras24x140   |                    |               |            | S355 | Sloup                  |
| 74    | Tras24x150   |                    |               |            | S355 | Sloup                  |
| 75    | Tras24x160   |                    |               |            | S355 | Sloup                  |
| 76    | Tras24x170   |                    |               |            | S355 | Sloup                  |
| 77    | Tras24x180   |                    |               |            | S355 | Sloup                  |
| 78    | Tras24x190   |                    |               |            | S355 | Sloup                  |
| 79    | Tras24x200   |                    |               |            | S355 | Sloup                  |
| 80    | Tras24x210   |                    |               |            | S355 | Sloup                  |
| 81    | Tras24x220   |                    |               |            | S355 | Sloup                  |
| 82    | Tras24x230   |                    |               |            | S355 | Sloup                  |
| 83    | Tras24x240   |                    |               |            | S355 | Sloup                  |
| 84    | Tras24x250   |                    |               |            | S355 | Sloup                  |
| 85    | Tras24x260   |                    |               |            | S355 | Sloup                  |
| 86    | Tras24x270   |                    |               |            | S355 | Sloup                  |
| 87    | Tras24x280   |                    |               |            | S355 | Sloup                  |
| 88    | Tras24x290   |                    |               |            | S355 | Sloup                  |
| 89    | Tras24x300   |                    |               |            | S355 | Sloup                  |
| 90    | Tras24x310   |                    |               |            | S355 | Sloup                  |
| 91    | Tras24x320   |                    |               |            | S355 | Sloup                  |
| 92    | Tras24x330   |                    |               |            | S355 | Sloup                  |
| 93    | Tras24x340   |                    |               |            | S355 | Sloup                  |
| 94    | Tras24x350   |                    |               |            | S355 | Sloup                  |
| 95    | Tras24x360   |                    |               |            | S355 | Sloup                  |
| 96    | Tras24x370   |                    |               |            | S355 | Sloup                  |
| 97    | Tras24x380   |                    |               |            | S355 | Sloup                  |
| 98    | Tras24x390   |                    |               |            | S355 | Sloup                  |
| 99    | Tras24x400   |                    |               |            | S355 | Sloup                  |
| 100   | Tras24x410   |                    |               |            | S355 | Sloup                  |
| 101   | Tras24x420   |                    |               |            | S355 | Sloup                  |
| 102   | Tras24x430   |                    |               |            | S355 | Sloup                  |
| 103   | Tras24x440   |                    |               |            | S355 | Sloup                  |
| 104   | Tras24x450   |                    |               |            | S355 | Sloup                  |
| 105   | Tras24x460   |                    |               |            | S355 | Sloup                  |
| 106   | Tras24x470   |                    |               |            | S355 | Sloup                  |
| 107   | Tras24x480   |                    |               |            | S355 | Sloup                  |
| 108   | Tras24x490   |                    |               |            | S355 | Sloup                  |
| 109   | Tras24x500   |                    |               |            | S355 | Sloup                  |
| 110   | Tras24x510   |                    |               |            | S355 | Sloup                  |
| 111   | Tras24x520   |                    |               |            | S355 | Sloup                  |
| 112   | Tras24x530   |                    |               |            | S355 | Sloup                  |
| 113   | Tras24x540   |                    |               |            | S355 | Sloup                  |
| 114   | Tras24x550   |                    |               |            | S355 | Sloup                  |
| 115   | Tras24x560   |                    |               |            | S355 | Sloup                  |
| 116   | Tras24x570   |                    |               |            | S355 | Sloup                  |
| 117   | Tras24x580   |                    |               |            | S355 | Sloup                  |
| 118   | Tras24x590   |                    |               |            | S355 | Sloup                  |
| 119   | Tras24x600   |                    |               |            | S355 | Sloup                  |
| 120   | Tras24x610   |                    |               |            | S355 | Sloup                  |
| 121   | Tras24x620   |                    |               |            | S355 | Sloup                  |
| 122   | Tras24x630   |                    |               |            | S355 | Sloup                  |
| 123   | Tras24x640   |                    |               |            | S355 | Sloup                  |
| 124   | Tras24x650   |                    |               |            | S355 | Sloup                  |
| 125   | Tras24x660   |                    |               |            | S355 | Sloup                  |
| 126   | Tras24x670   |                    |               |            | S355 | Sloup                  |
| 127   | Tras24x680   |                    |               |            | S355 | Sloup                  |
| 128   | Tras24x690   |                    |               |            | S355 | Sloup                  |
| 129   | Tras24x700   |                    |               |            | S355 | Sloup                  |
| 130   | Tras24x710   |                    |               |            | S355 | Sloup                  |
| 131   | Tras24x720   |                    |               |            | S355 | Sloup                  |
| 132   | Tras24x730   |                    |               |            | S355 | Sloup                  |
| 133   | Tras24x740   |                    |               |            | S355 | Sloup                  |
| 134   | Tras24x750   |                    |               |            | S355 | Sloup                  |
| 135   | Tras24x760   |                    |               |            | S355 | Sloup                  |
| 136   | Tras24x770   |                    |               |            | S355 | Sloup                  |
| 137   | Tras24x780   |                    |               |            | S355 | Sloup                  |
| 138   | Tras24x790   |                    |               |            | S355 | Sloup                  |
| 139   | Tras24x800   |                    |               |            | S355 | Sloup                  |
| 140   | Tras24x810   |                    |               |            | S355 | Sloup                  |
| 141   | Tras24x820   |                    |               |            | S355 | Sloup                  |
| 142   | Tras24x830   |                    |               |            | S355 | Sloup                  |
| 143   | Tras24x840   |                    |               |            | S355 | Sloup                  |
| 144   | Tras24x850   |                    |               |            | S355 | Sloup                  |
| 145   | Tras24x860   |                    |               |            | S355 | Sloup                  |
| 146   | Tras24x870   |                    |               |            | S355 | Sloup                  |
| 147   | Tras24x880   |                    |               |            | S355 | Sloup                  |
| 148   | Tras24x890   |                    |               |            | S355 | Sloup                  |
| 149   | Tras24x900   |                    |               |            | S355 | Sloup                  |
| 150   | Tras24x910   |                    |               |            | S355 | Sloup                  |
| 151   | Tras24x920   |                    |               |            | S355 | Sloup                  |
| 152   | Tras24x930   |                    |               |            | S355 | Sloup                  |
| 153   | Tras24x940   |                    |               |            | S355 | Sloup                  |
| 154   | Tras24x950   |                    |               |            | S355 | Sloup                  |
| 155   | Tras24x960   |                    |               |            | S355 | Sloup                  |
| 156   | Tras24x970   |                    |               |            | S355 | Sloup                  |
| 157   | Tras24x980   |                    |               |            | S355 | Sloup                  |
| 158   | Tras24x990   |                    |               |            | S355 | Sloup                  |
| 159   | Tras24x1000  |                    |               |            | S355 | Sloup                  |
| 160   | Tras24x1010  |                    |               |            | S355 | Sloup                  |
| 161   | Tras24x1020  |                    |               |            | S355 | Sloup                  |
| 162   | Tras24x1030  |                    |               |            | S355 | Sloup                  |
| 163   | Tras24x1040  |                    |               |            | S355 | Sloup                  |
| 164   | Tras24x1050  |                    |               |            | S355 | Sloup                  |
| 165   | Tras24x1060  |                    |               |            | S355 | Sloup                  |
| 166   | Tras24x1070  |                    |               |            | S355 | Sloup                  |
| 167   | Tras24x1080  |                    |               |            | S355 | Sloup                  |
| 168   | Tras24x1090  |                    |               |            | S355 | Sloup                  |
| 169   | Tras24x1100  |                    |               |            | S355 | Sloup                  |
| 170   | Tras24x1110  |                    |               |            | S355 | Sloup                  |
| 171   | Tras24x1120  |                    |               |            | S355 | Sloup                  |
| 172   | Tras24x1130  |                    |               |            | S355 | Sloup                  |
| 173   | Tras24x1140  |                    |               |            | S355 | Sloup                  |
| 174   | Tras24x1150  |                    |               |            | S355 | Sloup                  |
| 175   | Tras24x1160  |                    |               |            | S355 | Sloup                  |
| 176   | Tras24x1170  |                    |               |            | S355 | Sloup                  |
| 177   | Tras24x1180  |                    |               |            | S355 | Sloup                  |
| 178   | Tras24x1190  |                    |               |            | S355 | Sloup                  |
| 179   | Tras24x1200  |                    |               |            | S355 | Sloup                  |
| 180   | Tras24x1210  |                    |               |            | S355 | Sloup                  |
| 181   | Tras24x1220  |                    |               |            | S355 | Sloup                  |
| 182   | Tras24x1230  |                    |               |            | S355 | Sloup                  |
| 183   | Tras24x1240  |                    |               |            | S355 | Sloup                  |
| 184   | Tras24x1250  |                    |               |            | S355 | Sloup                  |
| 185   | Tras24x1260  |                    |               |            | S355 | Sloup                  |
| 186   | Tras24x1270  |                    |               |            | S355 | Sloup                  |
| 187   | Tras24x1280  |                    |               |            | S355 | Sloup                  |
| 188   | Tras24x1290  |                    |               |            | S355 | Sloup                  |
| 189   | Tras24x1300  |                    |               |            | S355 | Sloup                  |
| 190   | Tras24x1310  |                    |               |            | S355 | Sloup                  |
| 191   | Tras24x1320  |                    |               |            | S355 | Sloup                  |
| 192   | Tras24x1330  |                    |               |            | S355 | Sloup                  |
| 193   | Tras24x1340  |                    |               |            | S355 | Sloup                  |
| 194   | Tras24x1350  |                    |               |            | S355 | Sloup                  |
| 195   | Tras24x1360  |                    |               |            | S355 | Sloup                  |
| 196   | Tras24x1370  |                    |               |            | S355 | Sloup                  |
| 197   | Tras24x1380  |                    |               |            | S355 | Sloup                  |